

# SmallRig

## Advanced Cage Kit for Blackmagic Design Cinema 6K

---

Blackmagic Design Cinema 6K 进阶拓展框套件

Operating Instruction / 操作指引

- Thank you for purchasing SmallRig's product.  
感谢您购买 SmallRig 产品。
- Please read this Operating Instruction carefully.  
使用本产品之前，请仔细阅读操作指引。
- Please follow the safety warnings.  
请注意所有警告提示并遵循使用操作指引的所有指令。

## Specifications / 产品参数

SKU	4785	4574	4575
Product Name 产品名称	Camera Cage for Blackmagic Design Cinema 6K 拓展框	Basic Cage Kit for Blackmagic Design Cinema 6K 基础拓展框套件	Advanced Cage Kit for Blackmagic Design Cinema 6K 进阶拓展框套件
Material(s) 主要材质	Aluminum Alloy, Stainless Steel 铝合金、不锈钢	Aluminum Alloy, Stainless Steel 铝合金、不锈钢	Aluminum Alloy, Stainless Steel 铝合金、不锈钢
Product Weight 产品重量	13.4 ± 0.2oz 381.2 ± 5.0g	21.1 ± 0.2oz 597.7 ± 5.0g	37.9 ± 0.2oz 1074.0 ± 5.0g
Product Dimensions 产品尺寸	7.6 × 4.6 × 5.6in 194.5 × 116.2 × 141.8mm	8.6 × 5.3 × 8.3in 218.6 × 135.0 × 210.8mm	10.5 × 11.8 × 9.3in 266.3 × 300.0 × 236.0mm
In the Box 包装清单	Cage 拓展框 × 1  Lens Mount Adapter Support 转接环支撑 × 1  M5 Screw M5 内六角螺丝 × 2	Cage 拓展框 × 1  Lens Mount Adapter Support 转接环支撑 × 1  ARRI-Type Top Handle 阿莱上手提 × 1  SSD Mount Bracket SSD 支架 × 1  HDMI & USB-C Cable Clamp HDMI & USB-C 线夹 × 1  M5 Screw M5 内六角螺丝 × 2  1/4"-20 Screw 1/4"-20 螺丝 × 1	Cage 拓展框 × 1  Lens Mount Adapter Support 转接环支撑 × 1  ARRI-Type Top Handle 阿莱上手提 × 1  HDMI & USB-C Cable Clamp HDMI & USB-C 线夹 × 1  SSD Mount Bracket SSD 支架 × 1  Baseplate 底座 × 1  Dual 15mm Rods 15mm 双管 × 1  M5 Screw M5 内六角螺丝 × 2  1/4"-20 Screw 1/4"-20 螺丝 × 2  Side Handle 侧手柄 × 1

## Cage Installation / 拓展框安装步骤

Step 1: Insert the camera into the cage from the back and secure it with two 1/4"-20 screws at the base.

第一步：将相机从后往前放入相机拓展框，通过底部两颗1/4"-20 螺丝与机身锁紧固定。

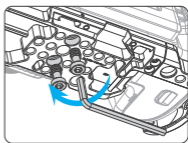
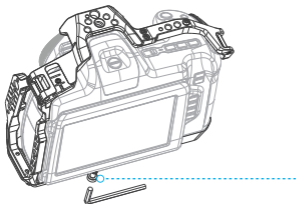

- \* The package does not include the camera.
- \* 相机机身需另购

Step 2: Remove the 1/4"-20 screw at the top of the cage, and secure the camera with it on the top.

第二步：取下拓展框顶部1/4"-20 螺丝，将其与相机顶部固定。

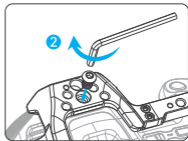
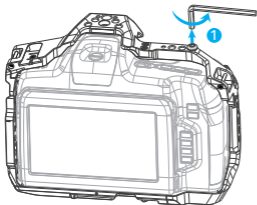

- \* The package does not include the camera.
- \* 相机机身需另购

## Lens Adapter Support Installation

### 转接环支撑安装步骤

Step 1: Secure the Lens Adapter Support to the cage with two M5 screws.

第一步：将转接环支撑通过两颗M5 螺丝与拓展框锁紧固定。

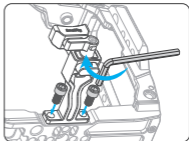
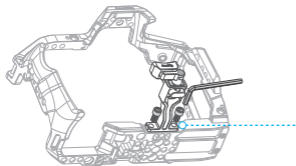

\* The package does not include the camera.

\* 相机机身需另购

Step 2: Adjust the height of the Lens Adapter Support with the knob according to the size of the lens adapter.

第二步：根据转接环尺寸调节转接环支撑的高度。

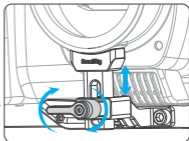
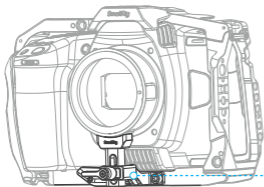

\* The package does not include the camera.

\* 相机机身需另购

## Top Handle Installation / 上提手柄安装步骤

Step 1: Align the top handle with the ARRI 3/8"-16 locating hole on the cage.

第一步：将上手提对准拓展框的阿莱 (ARRI) 定位孔。

Step 2: Tighten the ARRI 3/8"-16 locating screw by the included Allen wrench.

第二步：拧紧阿莱 (ARRI) 定位螺丝，使用六角扳手加固锁紧。

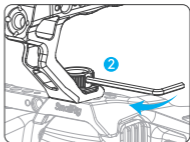
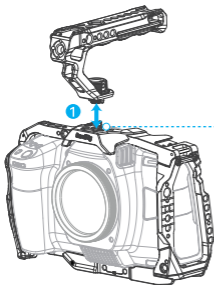

- \* The package does not include the camera.
- \* 相机机身需另购

## HDMI & USB-C Cable Clamp Installation Instruction

### HDMI & USB-C 线夹安装步骤

Step 1: Install the cable clamp to the cage by tightening the two thumbscrews.

第一步：通过两颗手拧螺丝，将线夹和拓展框锁紧固定。

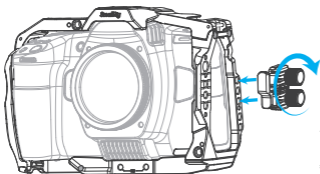

- \* The package does not include the camera.
- \* 相机机身需另购

Step 2: Insert the HDMI & USB-C cable.

第二步：插入HDMI & USB-C线。

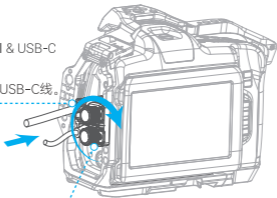

Step 3: Tighten the thumbscrews to secure the cable.

第三步：拧紧手拧螺丝固定线材。

\* The package does not include the camera.

\* 相机机身需另购

## SSD Clamp Installation / SSD硬盘固定夹安装步骤

Method 1: Slide the SSD clamp into the cold shoe mount on the left of the cage and secure the SSD cable with the thumbscrew.

安装方式一：将SSD硬盘固定夹划入拓展框左侧的冷靴座中，并通过手拧螺丝固定线材。

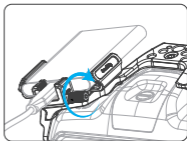
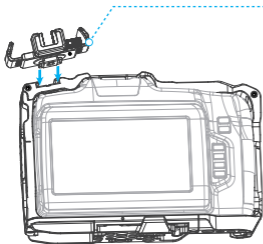

\* The package does not include the camera.

\* 相机机身需另购

Method 2: Secure the SSD clamp to the cage with one 1/4"-20 screw and secure the SSD cable with the thumbscrew.

安装方式二：通过一颗1/4"-20 螺丝将SSD硬盘固定架与拓展框锁紧固定。

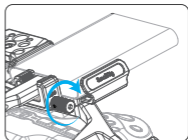
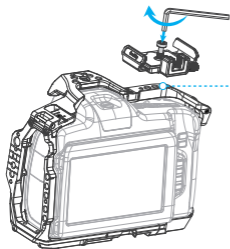

- \* The package does not include the camera.
- \* 相机机身需另购

## Rotating Side Handle Installation

### 旋转侧手柄安装步骤

Step 1: Loosen the knob and slide it into the cage.

第一步：拧松旋钮旋转，划入安装。

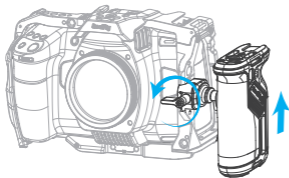

- \* The package does not include the camera.
- \* 相机机身需另购

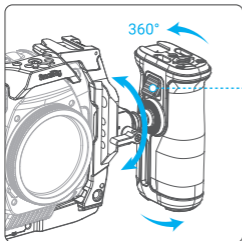

Step 2: Push the button to enable 360° bi-directional rotation for seamless operation.

第二步: 按压按钮, 即可双向无极 360° 旋转。

## LWS Baseplate with Dual 15mm Rod Clamp and 15mm Rod Installation

### LWS 15mm 双管底座和 15mm 双管安装步骤

Step 1: Secure the LWS baseplate to the cage with the two screws.

第一步: 通过两颗螺丝, 将底座和拓展框锁紧固定。

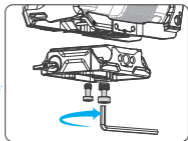
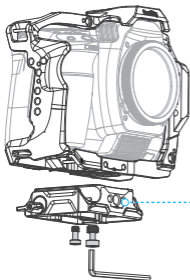

- \* The package does not include the camera.
- \* 相机机身需另购



Step 2: Loosen the knobs on both sides, slide in the 15mm rods, then tighten the knobs.

第二步：拧松双侧旋钮，划入15mm双管，拧紧固定。

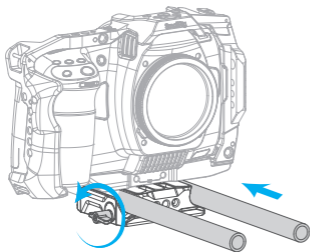

\* The package does not include the camera.

\* 相机机身需另购

Manufacturer: Shenzhen Leqi Innovation Co., Ltd.

Add: Rooms 103, 501 and 601, Building 5, Fenghe Industrial Park, Nos. 1301-50 Guanguang Road, Longhua District, Shenzhen, Guangdong, China.

制造商：深圳市乐其创新股份有限公司

地址：中国广东省深圳市龙华区观澜街道新澜社区观光路 1301-50 号丰和工业园  
厂房 5 栋 103、501、601

Consignor: Shenzhen LC Co., Ltd.

Add: Rooms 602, Building 5, Fenghe Industrial Park, No. 1301-50 Guanguang Road, Xinlan Community, Guanlan Street, Longhua District, Shenzhen, Guangdong, China.

委托商：深圳市乐长科技有限公司

地址：中国广东省深圳市龙华区观澜街道新澜社区观光路 1301-50 号丰和工业园  
厂房 5 栋 602



FREE YOUR DREAM

执行标准: GB/T 26572-2011

LQ-P1302-18

CE RoHS



Made in China

中国制造

