

**SmallRig**

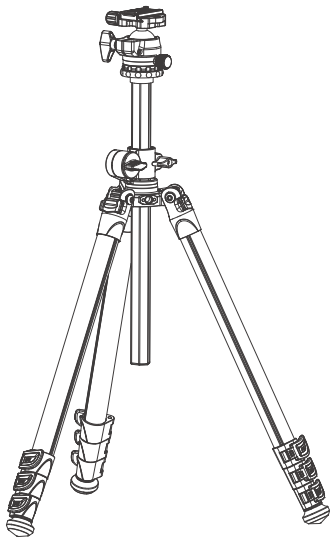

**Lateral Center Column  
Tripod CT200**

User Manual

In order to ensure user's safety and prevent the product damages caused by any improper use, please carefully read the "Warnings" below and properly keep this User Manual for future reference.

## Foreword

Thank you for purchasing SmallRig's product.

## Warnings

- Please read this User Manual carefully.
- Please keep the User Manual properly, and be sure to attach this User Manual when handing over the product to others.
- Please heed all warnings and follow all instructions in the owner's manual.

## In the Box

Tripod Kit	× 1	User Manual	× 1	Smartphone Holder	× 1
Allen Wrench	× 1	Carrying Bag	× 1	Weight Bag	× 1

## Product Details

- ① Quick-Release Plate
- ② Bubble Level
- ③ Plate Clamp
- ④ Pan Locking Knob
- ⑤ Panoramic Base with 360° Markings
- ⑥ Plate Locking Knob
- ⑦ Main Locking Knob

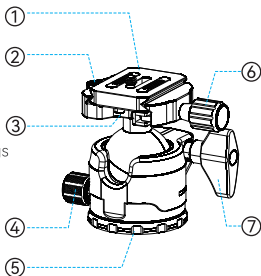



- ① Column Angle Adjustment Locking Knob
- ② Bubble Level
- ③ Female Screw for Accessories
- ④ Column Locking Knob
- ⑤ Horizontal Locking Knob
- ⑥ Leg Angle Adjustment Lock
- ⑦ Spiked Feet
- ⑧ Removable Rubber Feet
- ⑨ Flip Locking Lever

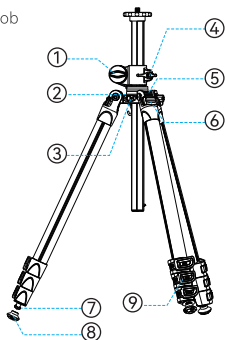

## Adjusting the Ball Head

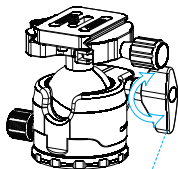

Main Locking Knob

Turn the main locking knob counterclockwise to unlock the head and clockwise to lock it. Ensure that the main locking knob is firmly tightened before letting go of the camera.

## Removing the Quick Release Plate

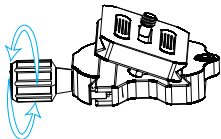

Turn the Plate Locking Knob counter-clockwise to remove the plate and clockwise to tighten it.

## Attaching Accessories

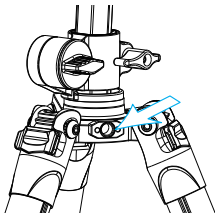

The tripod is outfitted with a 1/4" female thread which can be used to attach accessories, such as articulating arms that can in turn support monitors, lights, microphones, etc.

## Extending Tripod Legs

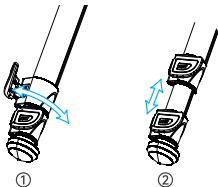

Lift up the leg tube flip locking lever to loosen the leg tube, adjust the height to the ideal working condition, and then press down the flip locking lever to tighten the leg tube for use.

## Adjusting Leg Angle

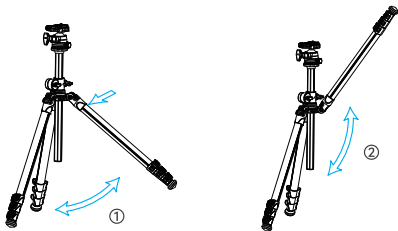

Each Leg can be adjusted by pulling the Leg Angle Adjustment Lock out and selecting one of the three positions. Please make sure that the Leg Angle Adjustment Lock is securely pushed back into the lock position after you have selected the desired leg angle.

# Using the Short Center Column

## Low-Angle Setup

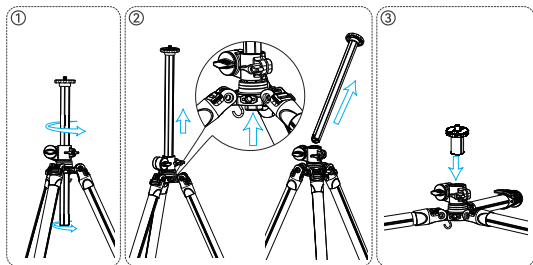

- ① Loosen the Column Locking Knob and raise the center column until it stops.
- ② While holding the center column with one hand, press the locking button at the bottom of the center column, then pull the center column out of the tripod.
- ③ Insert the short column and tighten the Column Locking Knob until secure.

## Converting to a Monopod

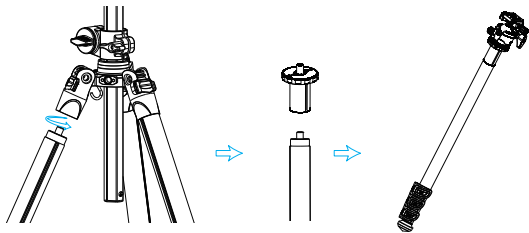

The leg with foam grip can be unscrewed from the tripod and used as a monopod.

1. Unscrew the monopod leg from the tripod.
2. Screw the provided short column onto the top of the monopod leg.

# Adjusting the Center Column

## 1. Vertical Column Positioning

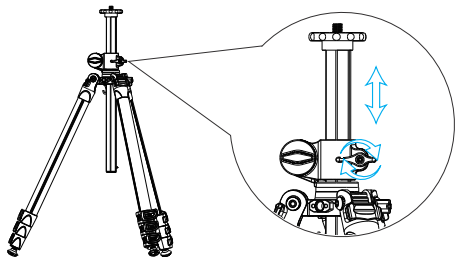

To raise or lower the center column, loosen the Column Locking Knob and set the center column to the desired position. While holding the center column in position, tighten the Column Locking Knob to lock the center column in position. Don't over-tighten the Column Locking Knob, as this could damage the threads.

## 2. Angular and Horizontal Column Positioning

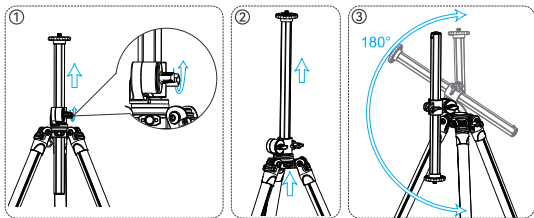

- ① Loosen the Column Locking Knob and raise the center column to its maximum height.
- ② While holding the center column with one hand, press the locking button at the bottom of the center column, and raise the center column until it clears the main casting.
- ③ Loosen the Column Angle Adjustment Locking Knob and position the center column at the desired angle. Tighten both the Column Locking Knob and Column Angle Adjustment Locking Knob.

### 3. Center Column Panning and Rotation

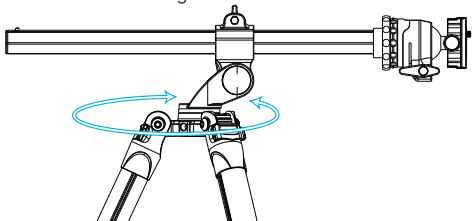

Loosen the Horizontal Locking Knob, swivel the center column around the tripod as desired. Tighten the Horizontal Locking Knob until secure.

### 4. Column Returning to the Upright Position

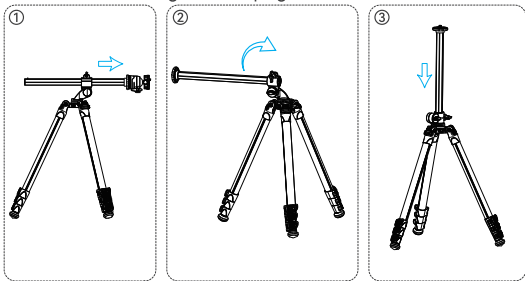

## Service Warranty

Please keep your original receipt and guarantee card. Be sure the dealer has written on it the date of purchase and SN of the product. These are required for warranty service.

#### After-sale warranty terms

1. 7 Days DOA Return Policy: Within 7 days from the date of the package receipt, return or replacement can be done if the item received is malfunctioning or physical damaged (not caused by human abused), return shipping cost will be on SmallRig's charge.
2. SmallRig products are entitled to warranty services as of the date of payment.
  - Electronic products (except V mount battery): 1-year warranty, 1-year free maintenance.
  - V mount battery: 2-year warranty, 2-year free maintenance.
  - Non-electronic products: 2-year warranty, 2-year free maintenance.

Note: In case of any conflict between our warranty period policy and applicable laws and

regulations of the country / region where the products are sold, the latter shall prevail.

### This warranty does not cover

1. If users fail to adhere to the "Operating Instruction" or any "Warnings" stated in the user manual, resulting in a quality failure, it falls outside the scope of warranty coverage.
2. The product identification or SN label is removed or defaced in any way.
3. Product damage caused by problems not attributable to the quality of the products such as improper use of the products.
4. Product damage caused by unauthorized modification, disassembly, repair and other acts.
5. Product damage caused by fires, floods, lightning and other force majeure factors.

### Warranty Mode

• For the products within the scope of warranty, SmallRig will repair or replace them on the basis of specific failures; the repaired / replaced products / parts are entitled to the remaining part of the original warranty period.

### Contact Information

• You're advised to contact the online customer service personnel of corresponding shopping platform and submit a repair service application.

• You may also apply for repair service through SmallRig's service email.

Service Email: support@smallrig.com

For more support information: [www.smallrig.com/support](http://www.smallrig.com/support)

### Guarantee Card

ID No.	
Item Name	
Purchase Date	
User Name	
Mobile	
Address	
Receipt	

EC	REP	Prolinx GmbH Brehmstr.56,40239 Duesseldorf Germany eu@eulinx.eu
----	-----	---

UK	REP	Prolinx Global LTD 27 Old Gloucester Street London,WC1N3AX, UK eu@eulinx.eu
----	-----	---

Manufacturer: Shenzhen Leqi Network Technology Co., Ltd.

Add: Rooms 103, 501 and 601, Building 5, Fenghe Industrial Park, Nos. 1301-50 Guanguang Road, Longhua District, Shenzhen, Guangdong, China.

Consignor: Shenzhen LC Co., Ltd

Add: Rooms 602, Building 5, Fenghe Industrial Park, No. 1301-50 Guanguang Road, Xinlan Community, Guanlan Street, Longhua District, Shenzhen, Guangdong, China.

 **RoHS**



[www.smallrig.com](http://www.smallrig.com)

Made in China

WE ARE HERE FOR YOU  
服务与支持

ETICHETTATURA AMBIENTALE  
ENVIRONMENTAL LABELING

# SmallRig

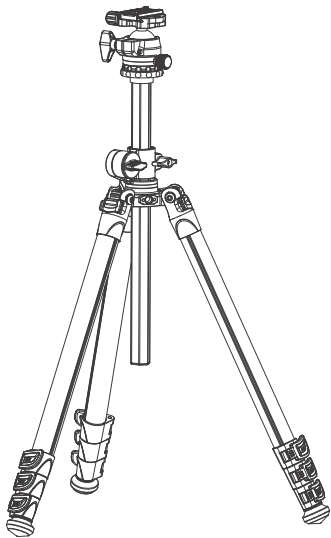

## 专业俯拍三脚架 CT200

用户手册

为了保障使用者的安全以及防止不当使用导致产品损坏，请认真阅读本用户手册，并妥善保管，以备随时查阅。

## 前言

感谢您购买 SmallRig 产品。

## 重要提示

- 使用本产品之前，请仔细阅读用户手册。
- 请妥善保管用户手册，将产品交给他人使用时，请务必附带本用户手册。
- 请注意所有警告提示并遵循使用用户手册内的所有指令。

## 包装清单

三脚架套件 × 1

用户手册 × 1

手机夹 × 1

六角扳手 × 1

收纳包 × 1

配重袋 × 1

## 产品介绍

- ① 快装板
- ② 气泡水平仪
- ③ 快装夹
- ④ 底座锁紧旋钮
- ⑤ 360°水平刻度
- ⑥ 快装夹锁紧旋钮
- ⑦ 球体锁紧旋钮

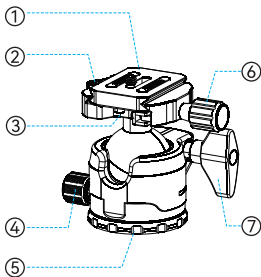



- ① 中轴角度调节锁紧旋钮
- ② 气泡水平仪
- ③ 外接孔
- ④ 中轴锁紧旋钮
- ⑤ 水平锁紧旋钮
- ⑥ 角度调节片
- ⑦ 脚钉
- ⑧ 可拆卸脚垫
- ⑨ 锁紧扳扣

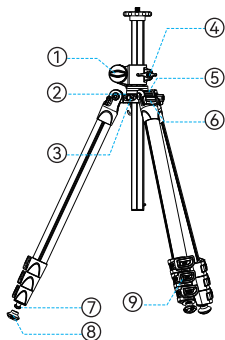

## 球形云台调整

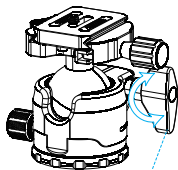

球体锁紧旋钮

逆时针旋转球体锁紧旋钮以松开云台球体，顺时针旋转球体锁紧旋钮则锁定云台球体。要确保球体锁紧旋钮被拧紧后再松开相机。

## 拆卸快装板

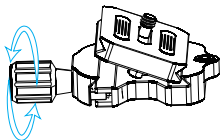

1. 逆时针拧松快装夹锁紧旋钮，即可卸下快装板。
2. 顺时针拧紧快装夹锁紧旋钮，即可安装快装板。

## 配件安装

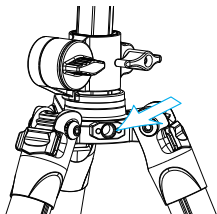

三脚架配备了1/4"内螺纹接口，可以用来连接各种配件，比如魔术臂、安装显示器、摄影灯、麦克风等。

## 三脚架高度调节

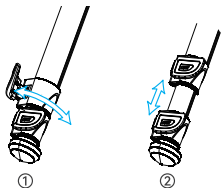

松开脚管锁，将脚管高度调整到理想的工作状态，锁紧脚管锁将腿管固定好以供使用。

## 三脚架角度调节

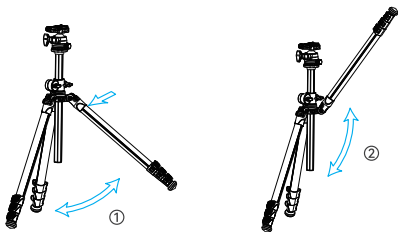

每根脚管都可以通过外拔式角度调节片实现高中低三档角度调节。调整好角度后，请确保把角度调节片推到锁紧的位置。

## 短中轴的使用

### 底角度拍摄设置

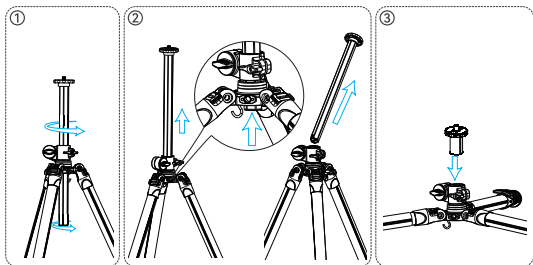

① 松开中轴锁紧旋钮，把中轴拉至最高处。

② 一手握住中轴，另一手按压中轴底部的保险按钮，届时保险限位块缩入，将中轴从三脚架重抽出。

③ 插入附赠的短中轴，拧紧中轴锁紧旋钮即可。

### 可变换独脚架

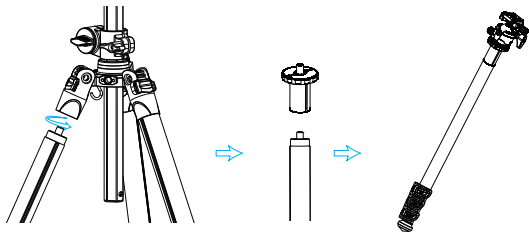

带有保护套的脚管可以拧下来并转换为独脚架使用。

1. 将带有保护套的脚管从脚管接头旋出。

2. 将取下的脚管装配与随附的短中轴，即可完成三脚架到独脚架的转换。

# 中轴操作

## 1. 中轴伸缩调节

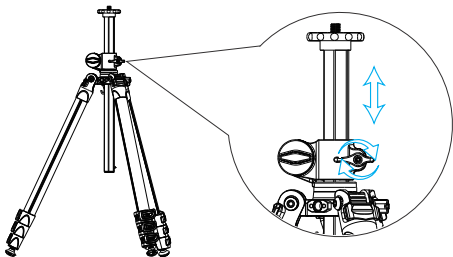

逆时针拧松中轴锁紧旋钮，把中轴调到合适位置，然后顺时针旋转中轴锁紧旋钮锁紧中轴。中轴上带有刻度，能帮助中轴定位。注意不要过度拧中轴锁紧旋钮，以免损坏螺纹。

## 2. 中轴角度调节

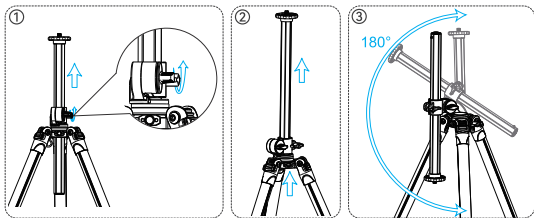

① 拧松中轴锁紧旋钮，将中轴拉至最高处。

② 一手握住中轴，另一手按压中轴底部的保险按钮，届时保险限位块缩入，将中轴升起，直至脱离三割座主题。

③ 拧松中轴角度调节锁紧旋钮，即可进行中轴角度调节，以及横置中轴功能。将中轴调节到理想角度，拧紧中轴锁紧旋钮和中轴角度调节锁紧旋钮即可。

### 3. 中轴水平旋转

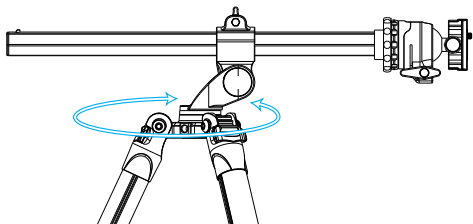

松开水平锁紧旋钮，即可对中轴进行水平360°旋转。调整至理想位置，拧紧水平锁紧旋钮直至牢固。

### 4. 中轴恢复垂直状态

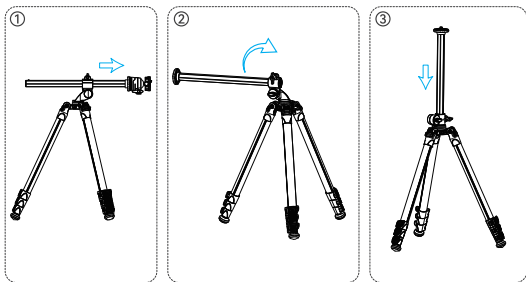

# 保修条款

请保留您的原始购买单据及保修卡,同时包含您的购买日期、产品序列号等,这些资料质保服务时均需要提供。

## 售后质保条款

1. “七天无理由包退 / 换”:自签收之日起7日内,用户可以选择换货 / 退货。

2. SmallRig 产品自下单付款之日起享有质保服务。

- 电子产品 (除V口电池):1年质保,1年免费保修服务。
- V口电池:2年质保,2年免费保修服务。
- 非电子产品:2年质保,2年免费保修服务。

注:若销售地国家或地区的适用法律法规有冲突的,以销售地国家或地区有关质保期的法律法规为准。

## 质保无效说明

1. 当用户违反操作指引或用户手册中“重要提示”任何一条导致的质量失效,不在质保范围内。
2. 产品序列号标识已经被撕毁或无法辨识,不在质保范围。
3. 产品使用不当等非产品本身质量问题,而造成的产品损坏,不在质保范围。
4. 非官方指导的私自改装、拆解、维修等行为而造成的损坏,不在质保范围。
5. 因火灾、水灾、雷击等不可抗力造成的产品损坏,不在质保范围。

## 维修方式

· 属于质保范围的,SmallRig 根据产品具体的故障对产品进行维修或更换;维修后的产品 / 部件享受原有保修期的剩余时长。

## 联系方式

- 建议您优先前往相应购买平台联系在线客服,提出产品维修申请。
- 您也可以通过 SmallRig 服务邮箱申请维修服务。

服务邮箱:support@smallrig.com

获取更多的服务信息:www.smallrig.com/support

## 保修卡

ID编号	
产品名称	
购买日期	
用户姓名	
用户电话	
用户地址	
购买单据	

制造商:深圳市乐其网络科技有限公司

LQ-P1096-18

地址:中国广东省深圳市龙华区观澜街道新澜社区观光路 1301-50 号丰和工业园厂房 5 栋 103、501、601

委托商:深圳市乐长科技有限公司

地址:中国广东省深圳市龙华区观澜街道新澜社区观光路 1301-50 号丰和工业园厂房 5 栋602



www.smallrig.com

执行标准:JB/T9434-2016

中国制造