

SmallRig

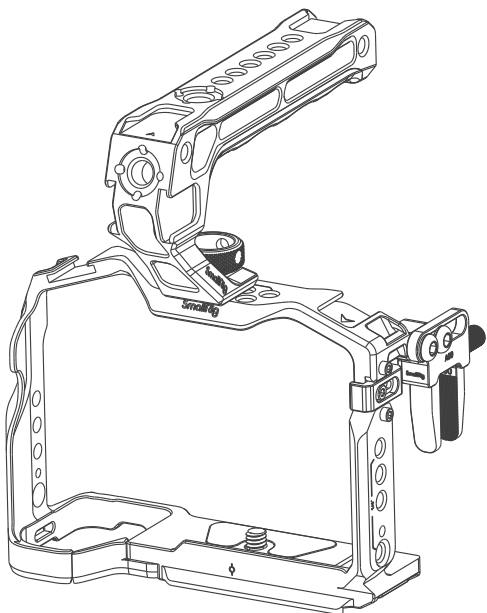

Cage Kit for Sony Alpha 7 III / Alpha 7R III User Manual

Foreword

Thank you for purchasing SmallRig product. For your and the item's safety, please read this product manual carefully and keep it well for future reference.

In the Box



Cage
× 1



HDMI Cable Clamp
× 1

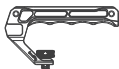

ARRI Locating
Handle × 1



1/4"-20 Screw
× 2



Allen Wrench
× 2

Product Detail Display

1. Cage

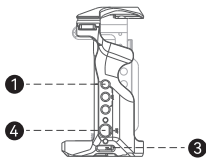
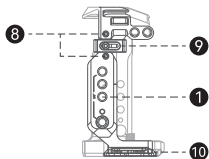
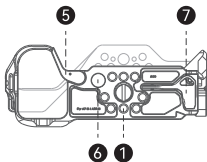
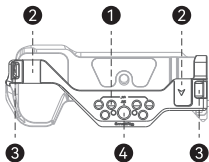

- ① 1/4"-20 Threaded Hole
- ② Cold Shoe Mount
- ③ Strap Hole / Slot
- ④ ARRI 3/8"-16 Locating Hole
- ⑤ Hinged Arm

- ⑥ QD Socket
- ⑦ Dual-Head Wrench
- ⑧ M2.5 Screw
- ⑨ Side Lock Adapter
- ⑩ Arca-Swiss Quick Release Plate

2. Handle

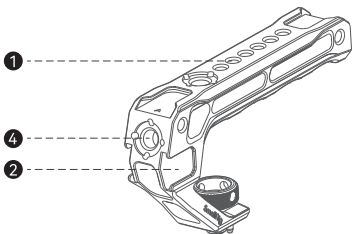

Cage Installation Introduction

- ① Remove the camera lens and the shoulder strap hooks on both sides.
* The package does not include the camera.

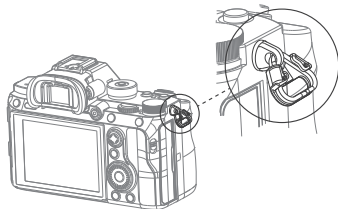

- ② Put the camera into the cage from back to front.

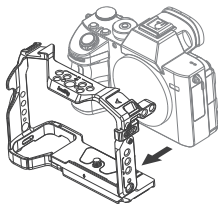

- ③ Use the Dual-Head Wrench to lock the bottom 1/4"-20 screw.

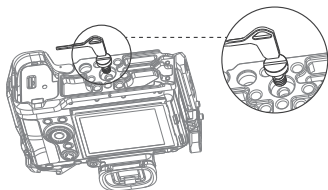

- ④ Use the Dual-Head Wrench to remove the M2.5 screw on the left side of the cage and lock it through the right shoulder strap hook hole to the cage.

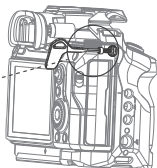

- ⑤ Use the Dual-Head Wrench to install the Side Lock Adapter to the hook hole of the shoulder strap and then lock it.

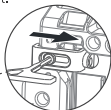
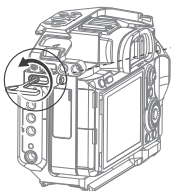

- ⑥ Remove the M2.5 screw on the left side of the cage and lock it through the left hook hole of the shoulder strap to the cage.

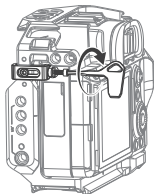

Handle Installation Introduction

- ① Align the Top Handle with the ARRI 3/8" - 16 Locating Hole of the cage and hand-tighten to secure.
② Reinforcement with included Allen Wrench.

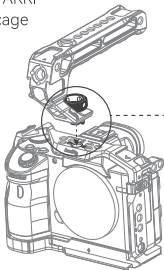

HDMI Cable Clamp Installation Introduction

- ① Open the camera HDMI cover and use the included 1/4"-20 screws and Allen Wrench to secure the cable clamp to the left side of the cage.
- ② Insert HDMI cable.
- ③ Tighten the thumbscrew to secure the cable.

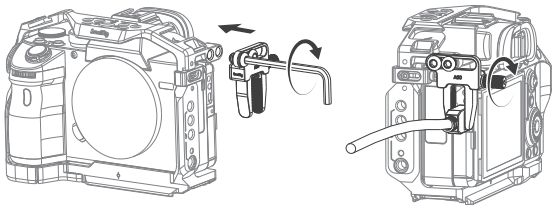

Battery Replacement

The battery can be installed or replaced after opening the Hinged Arm.

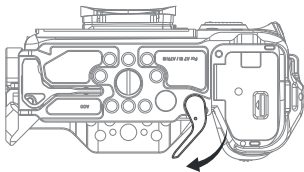

Compatibility

Sony Alpha 7 III
Sony Alpha 7R III

Specifications

Product Dimensions: 150.2 × 135.0 × 175.0mm
Product Weight: 315.0 ± 5.0g
Material(s): Aluminum Alloy, Stainless Steel, Silicone